

Müller
AUSTRIA

**ELECTRIC
COFFEE
GRINDER**

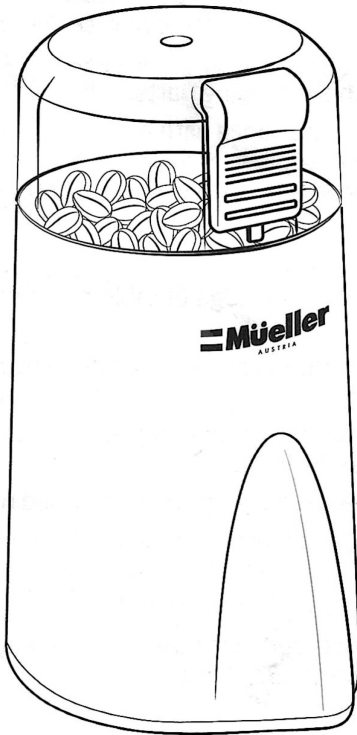

**MODEL:
550K-RED
550K-GREY
550K-BLACK
550K-WHITE**

USER MANUAL

Your satisfaction is guaranteed. If you are not completely satisfied with our Electric Coffee Grinder and the results it brings, we insist that you let us know. We'll help make the Electric Coffee Grinder work for you, or we'll refund your money.

IMPORTANT SAFEGUARDS

READ ALL OF THE INSTRUCTIONS CAREFULLY before using the appliance as it contains important instructions for the safety, operation and maintenance of the appliance.

1. To protect against risk of electrical shock, do not immerse cord, plug or grinder in water or other liquid.
2. This appliance is not intended for use by children.
3. Unplug from outlet when not in use, before putting on or taking off parts, before removing coffee and before cleaning.
4. Avoid contact with the moving parts.
5. Do not operate any appliance with a damaged cord or plug, or after the appliance malfunctions, or is dropped or damaged in any manner. Contact Mueller Customer Service.
6. Do not use outdoors.
7. Do not let cord hang over edge of table or counter, or touch hot surfaces.
8. Before using, check grinding bowl for presence of foreign objects.
9. This product is intended for grinding small quantities of roasted coffee beans.
10. Do not use appliance for other than intended use.
11. Do not place this appliance on or near a hot gas or electric burner, or in a heated oven.
12. Blades are sharp. Handle them carefully.
13. This product is intended for household use only. It is not intended for commercial use.

PRECAUTIONS

- Always place the unit on a flat, level surface.
- Switch off and unplug from power before cleaning.
- Do not remove the lid until blade has completely stopped.

1

- Do not attempt operation without the lid being in place.
- Do not immerse the motorized base or blade in liquid, or place in dishwasher. Only the transparent top cover may be washed.
- Do not attempt to chop ice.

PARTS IDENTIFICATION

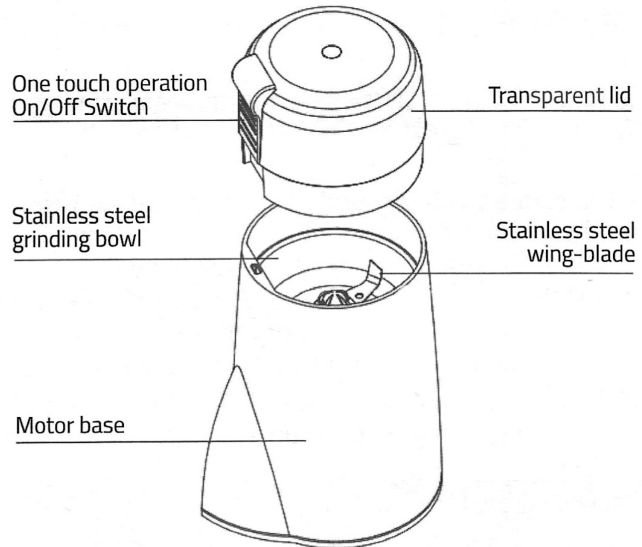

BEFORE THE FIRST USE

1. Wipe the stainless steel bowl, blade, and lid with a damp cloth.
2. Make sure the inside parts are completely dry before using.
3. Before connecting the product to the power supply, check that the power supply voltage and current rating corresponds with the power supply details shown on the product rating label.

2

OPERATING INSTRUCTIONS

1. Plug cord into outlet.
2. Remove lid from base of grinder. Make sure the stainless steel bowl is empty and clean.
3. Fill the stainless steel bowl with the desired quantity of coffee beans. Do not fill beans above the top of the stainless steel bowl.

Note: The grinder can contain up to 60 gr (2.1 oz) of coffee beans.

4. Place the lid onto grinder base.
5. Press and hold ON/OFF button to begin grinding. The device will grind as long as the ON/OFF button is pressed.

- The coffee will be ground fine or coarse depending on the amount of the grinding time. For example, a coarse grind would require less grinding time than a fine grind.

Please note: A safety feature of this grinder requires that the grinder will not operate unless the lid is in place.

6. To stop grinding, release pressure from ON/OFF button.
7. Remove plug from outlet.
8. When the grind is complete, turn the grinder upside down and gently tap the grounds into the lid. Then, while the grinder is still inverted, remove the clear plastic lid and pour the ground coffee into the coffee filter.

DO NOT OPERATE THE APPLIANCE FOR MORE THAN 20 SECONDS AT A TIME. LET THE APPLIANCE COOL DOWN FOR 1 MINUTE BEFORE RESUMING OPERATION.



COFFEE MEASUREMENT CHART

BEAN QUANTITY (coffee spoons)	=GROUND COFFEE (tbls.)	=YIELDS THIS MANY CUPS (5 oz. cup)
1 1/2 scoops	3 tbls.	2 cups
2 1/2 scoops	5 tbls.	4 cups
3 scoops	6 tbls.	6 cups
4 scoops	8 tbls.	8 cups
5 scoops	10 tbls.	10 cups
5 1/2 scoops	11 tbls.	12 cups

Note: This coffee grinder grinds up to 11 tablespoons of whole coffee beans.

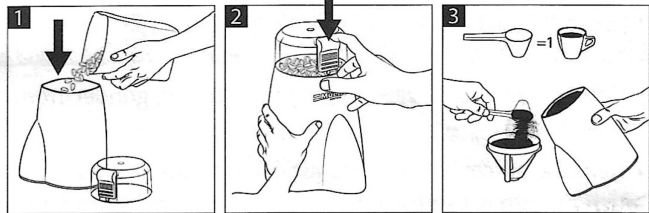

GRINDING SUGGESTIONS:

Some general guidelines for grinding are listed below. However, times will vary depending on the amount of coffee used and your personal preference. The best way to determine how coarse or fine to grind your coffee is to experiment with different grinds and coffee types to suit your taste.

Coarse grind (French Press / Percolator)	Medium grind (Automatic Drip Coffee)	Fine grind (Espresso Machine)
8-10 Seconds	10-15 Seconds	20 Seconds

For smaller batches of beans use less grind time.

Brewing Method	Grind
Turkish Coffee	Very fine grind
Electronic Espresso Machines	Fine grind
Stovetop Espresso or Filter	Medium grind
Plunger or Percolator	Coarse grind

COFFEE TIPS

- For a good cup of coffee only grind the amount you need for immediate use, as ground coffee quickly loses its flavor and aroma.
- Unused coffee beans can be stored in an airtight container in a freezer for up to 2 months.
- Coffee beans do not need to be defrosted before grinding and/or brewing.

CLEANING

- Before cleaning, always unplug your coffee grinder from the wall outlet.
- Remove all coffee grounds after each use. A small soft brush or cloth is helpful in removing ground coffee from the lid and blades.
- Wipe the inside of the grinder lid and blades very carefully with a damp cloth.
- Lid can be washed in warm water using a mild detergent.
- Motor base can be wiped down with a damp cloth.

DO NOT PLACE THIS COFFEE GRINDER IN WATER. DO NOT IMMERSE BLADES OR MOTOR BASE IN WATER OR ANY OTHER LIQUID.

- Do not try to oil or sharpen the blades.

TECHNICAL SPECIFICATIONS

Rated voltage 120 V~ 60 Hz

Rated power: 130 W

Maximum operating time: 20 seconds per cycle/1 minute cool down between cycles

Maximum capacity: 2.1 oz (60 g)

5



1 -Year Limited Warranty

This product is warranted to be free from defects in material and workmanship under normal use and service for one year from the date of the original purchase with the receipt. The manufacturer's obligation shall be limited to repairing or replacing any part of the product that is defective. Such warranty shall not apply to damages resulting from accidents, abuse, or misuse.



Your purchase comes with a 100% satisfaction guarantee from Müller

If you are not happy with the product for any reason, please contact us at support@muellerdirect.com or 1 (888)-632-9981 with your feedback or questions, and we will do our best to make things right for you!

6

